

Your Vehicle: 2006 Mazda Mazdaspeed6 L4-2.3L Turbo

Advertisement

Ask A Mechanic OnlineOver 20 certified mechanics online.
Ask a question. Get an answer ASAP.

Ask a Question

just
answer.[®][Vehicle](#) » [Technical Service Bulletins](#) » [All Technical Service Bulletins](#) » [Drivetrain - Oil Seepage From Transfer Case](#)[Notes](#)

Drivetrain - Oil Seepage From Transfer Case

Bulletin No: 03-001/08

Last Issued: 01/09/2008

Subject:

OIL SEEPAGE FROM [TRANSFER CASE](#)

APPLICABLE MODEL(S)/VINS

2006-2007 Mazdaspeed6 vehicles with VINs lower than JM1GG12L*7*108052 (produced before July 1, 2006)

DESCRIPTION

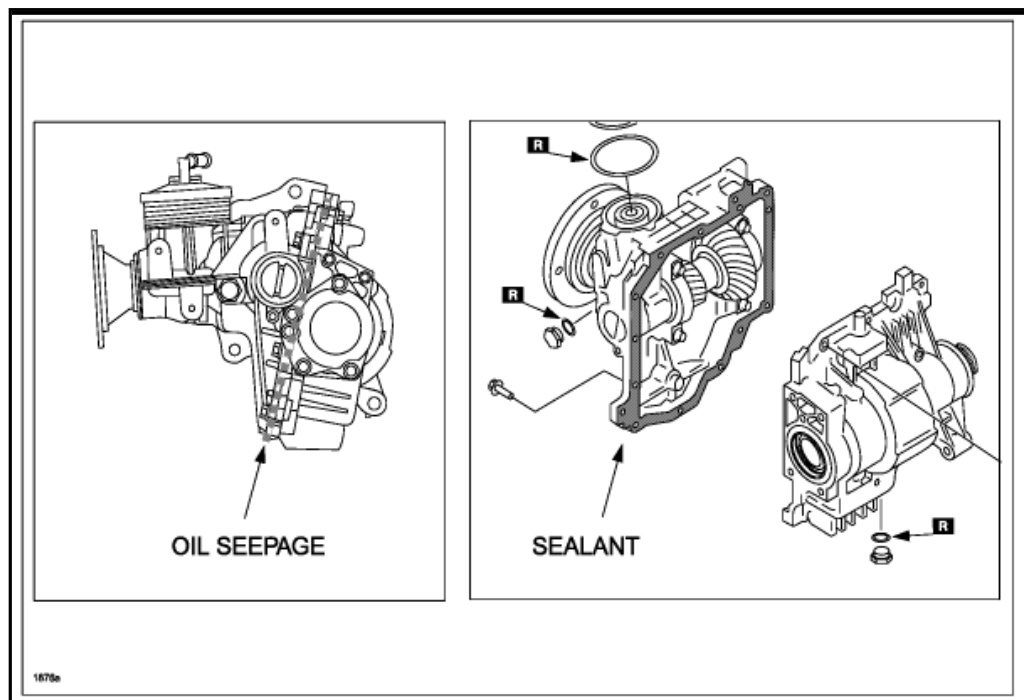
Some vehicles may experience oil seepage from the [transfer case](#) in the location shown.

This may be caused by insufficient cleaning of the mating surfaces of the front and rear cases before applying sealant.

The cleaning and assembly process has been improved during production.

Customers having this concern should have their vehicle repaired using the following repair procedure.

REPAIR PROCEDURE

1. Verify customer concern.
2. Remove [transfer case](#) according to Workshop Manual (section 05-17 TRANSFER REMOVAL/INSTALLATION).

3. Completely remove sealant and oil off contact surfaces and bolt holes of both case halves with Brake Clean.

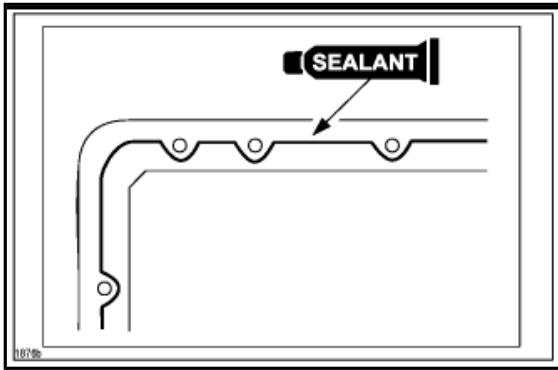

4. Apply locally sourced Permatex Ultra Grey RTV sealant to case as shown.

5. Reinstall transfer case according to Workshop Manual (section 05-17 TRANSFER REMOVAL/INSTALLATION).

6. Verify repair.

Part Number	Description	Qty.	Note
----	Permatex Ultra Grey RTV	1	Source sealant locally

PART(S) INFORMATION

NOTE:

- This warranty information applies only to verified customer complaints on vehicles eligible for warranty repair. Refer to the Warranty Wizard for warranty term information.
- Additional diagnostic time cannot be claimed for this repair.

Warranty Type	A
Symptom Code	76
Damage Code	9K
Part Number Main Cause	7777-19-038
Quantity	0
Operation Number / Labor Hours:	XXC5LXRX / 4.3 Hrs.

WARRANTY INFORMATION

CONSUMER NOTICE: The information and instructions in this bulletin are intended for use by skilled technicians. Mazda technicians utilize the proper tools / equipment and take training to correctly and safely maintain Mazda vehicles. These instructions should not be performed by "do-it-yourselfers." Consumers should not assume this bulletin applies to their vehicle or that their vehicle will develop the described concern. To determine if the information applies, consumers should contact their nearest authorized Mazda dealership.

Disclaimer

[Account](#) | [Vehicle](#) | [Help](#) | [Contact](#) | [Exit](#)

© 2011 ALLDATA, LLC. All Rights Reserved. [Trademarks](#) | [Privacy Policy](#) | [Terms and Conditions](#)